

EM NOSSA CIDADE EXISTEM DIVERSOS PONTOS TURÍSTICOS E NELES
PODEMOS PASSEAR COM A FAMÍLIA. ESTAS IMAGENS ABAIXO SÃO DE
ALGUNS DELES.

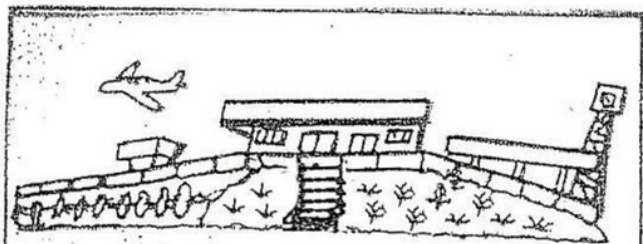

AEROPORTO

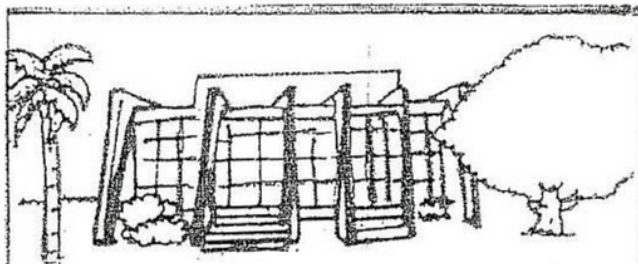

TEATRO

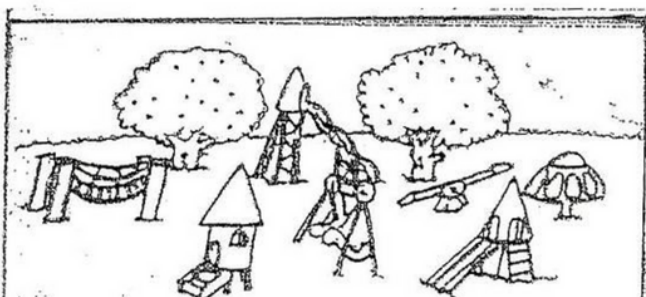

CIDADE DA CRIANÇA

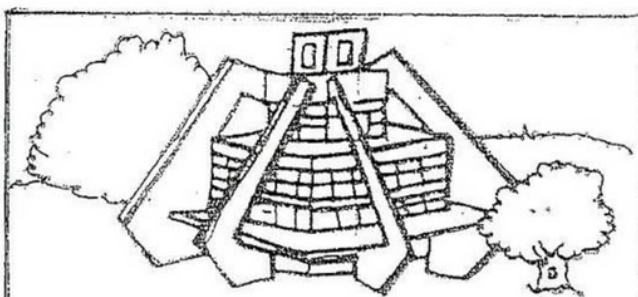

BIBLIOTECA MUNICIPAL

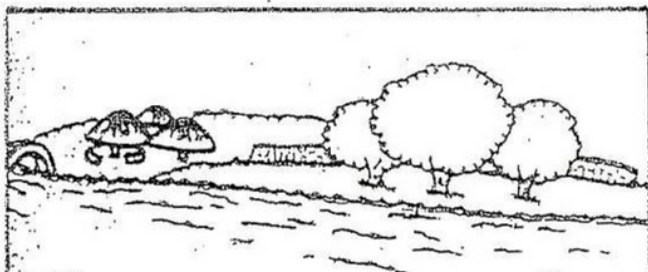

REPRESA MUNICIPAL

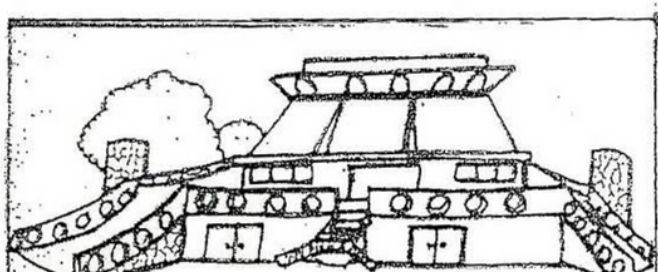

CATEDRAL

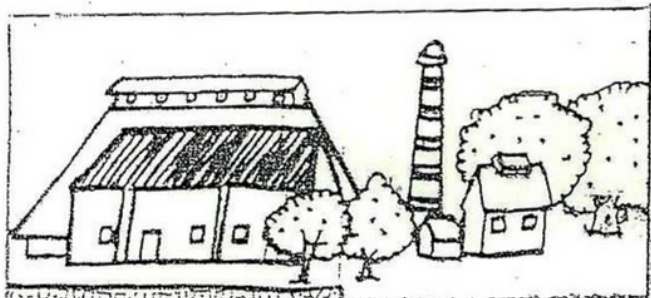

SWIFT

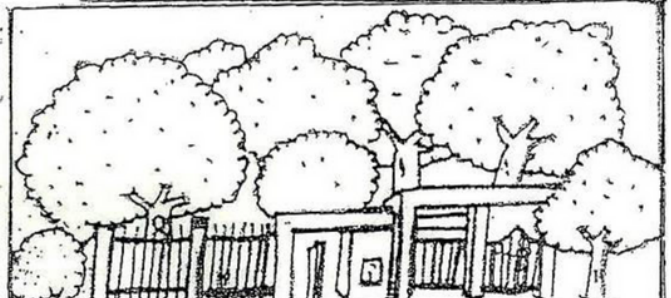

**ZOOLÓGICO
(BOSQUE)**

